

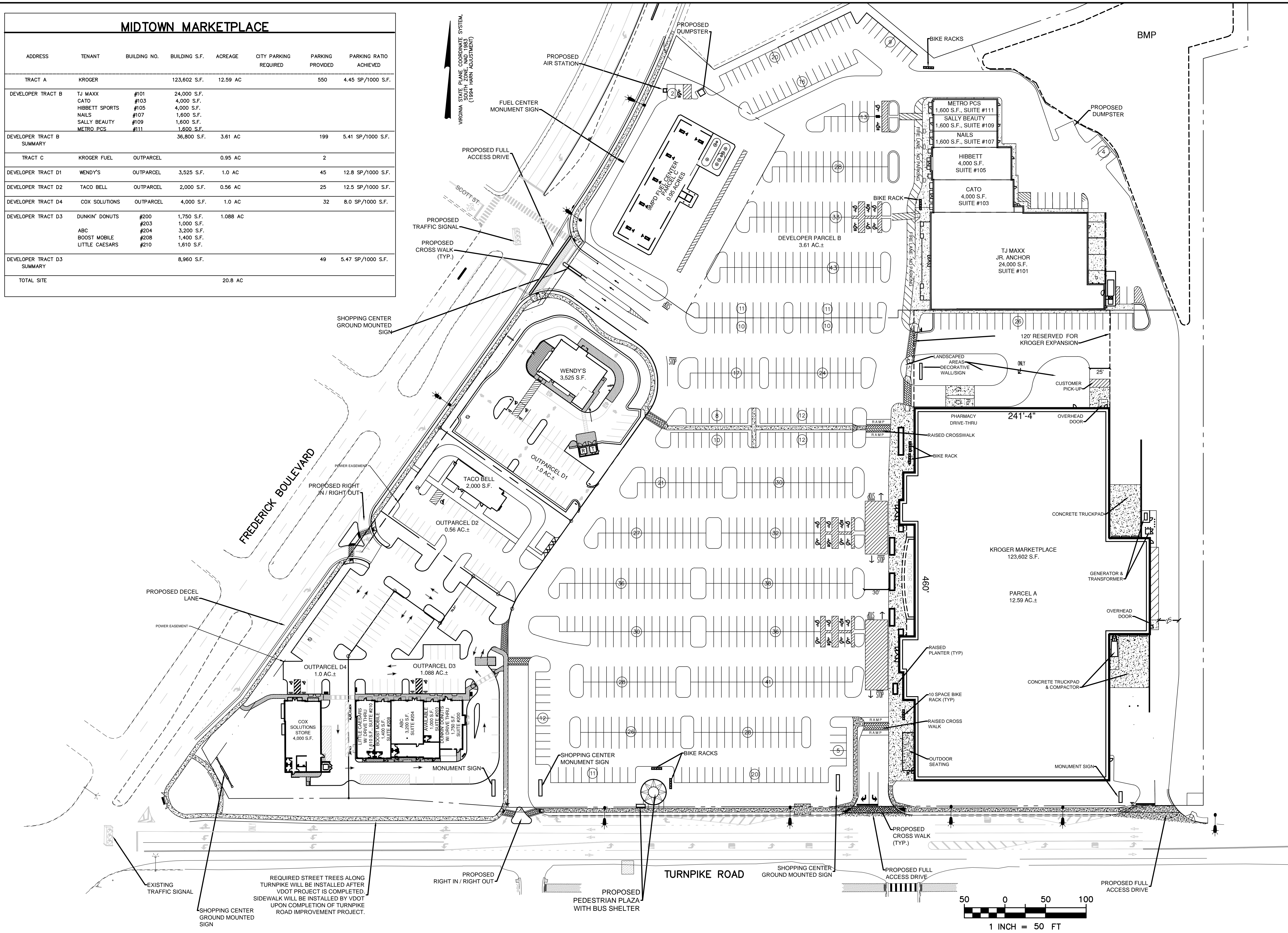

# MIDTOWN MARKETPLACE

ADDRESS	TENANT	BUILDING NO.	BUILDING S.F.	ACREAGE	CITY PARKING REQUIRED	PARKING PROVIDED	PARKING RATIO ACHIEVED
TRACT A	KROGER		123,602 S.F.	12.59 AC		550	4.45 SP/1000 S.F.
DEVELOPER TRACT B	TJ MAXX	#101	24,000 S.F.				
	CATO	#103	4,000 S.F.				
	HIBBETT SPORTS	#105	4,000 S.F.				
	NAILS	#107	1,600 S.F.				
	SALLY BEAUTY	#109	1,600 S.F.				
	METRO PCS	#111	1,600 S.F.				
DEVELOPER TRACT B SUMMARY			36,800 S.F.	3.61 AC		199	5.41 SP/1000 S.F.
TRACT C	KROGER FUEL	OUTPARCEL		0.95 AC		2	
DEVELOPER TRACT D1	WENDY'S	OUTPARCEL	3,525 S.F.	1.0 AC		45	12.8 SP/1000 S.F.
DEVELOPER TRACT D2	TACO BELL	OUTPARCEL	2,000 S.F.	0.56 AC		25	12.5 SP/1000 S.F.
DEVELOPER TRACT D4	COX SOLUTIONS	OUTPARCEL	4,000 S.F.	1.0 AC		32	8.0 SP/1000 S.F.
DEVELOPER TRACT D3	DUNKIN' DONUTS	#200	1,750 S.F.				
		#203	1,000 S.F.				
	ABC	#204	3,200 S.F.				
	BOOST MOBILE	#208	1,400 S.F.				
	LITTLE CAESARS	#210	1,610 S.F.				
DEVELOPER TRACT D3 SUMMARY			8,960 S.F.			49	5.47 SP/1000 S.F.
TOTAL SITE				20.8 AC			

**GADDY**  
ENGINEERING SERVICES, LLC  
CONTACT:  
MICHAEL S. GADDY, PE, LS  
757-289-5933  
508 N. BIRDNECK RD, SUITE D  
VIRGINIA BEACH, VA 23451

OVERALL SITE PLAN  
OSP-1  
**KROGER MIDTOWN MARKETPLACE**  
2900 TURNPIKE ROAD

SHEET  
**OSP-1**  
1 of 1 Sheets  
SCALE: 1" = 50'  
PROJ. NO.:

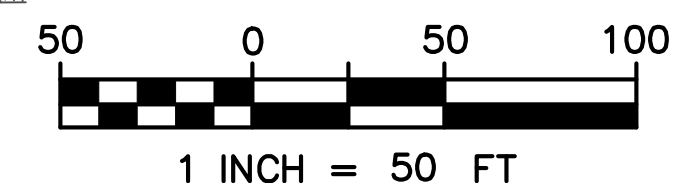

REVISION - DESCRIPTION  
REV. NO. REV. BY  
VIRGINIA  
PORTSMOUTH